

New

35kg Payload Pneumatic Quick Chuck Changer

“Safe” & “High-precision” chuck plate change



Before When inserting into the center shaft

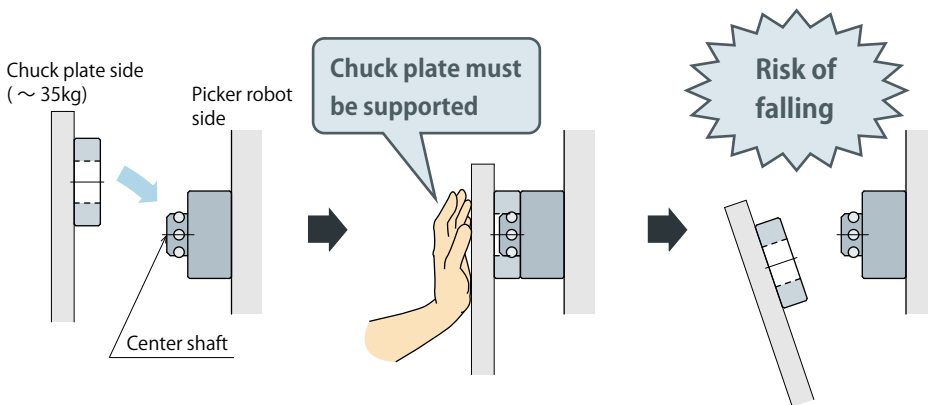

Insert the chuck plate into the center shaft.

Perform the pneumatic lock operation while supporting the inserted chuck plate by hand.

There is a risk of falling because it is necessary to release one hand to perform the lock operation.



Application example of using a robotic hand changer for chuck plate change

After Quick Chuck Changer Method



Insert the chuck plate into the upper pin.

When inserted, the chuck plate catches on the pin. It will not fall even if you release your hands before the pneumatic lock operation.※1

Enables "safe" locking of the chuck plate with no risk of dropping.

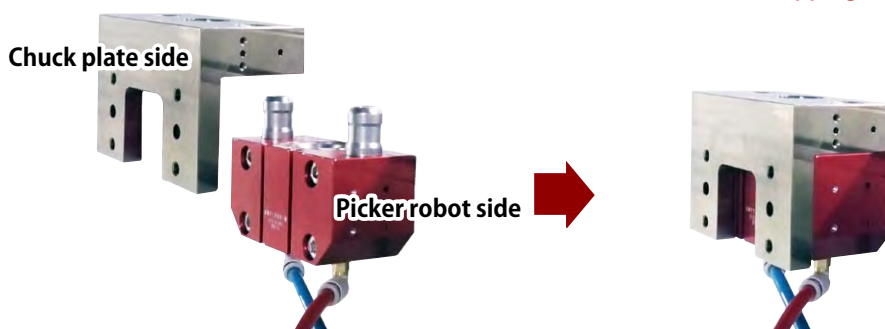

※1. Always lock the changer before operating the picker robot.

35kg Payload Pneumatic Quick Chuck Changer Model SWY1600-M/T

External Dimensions

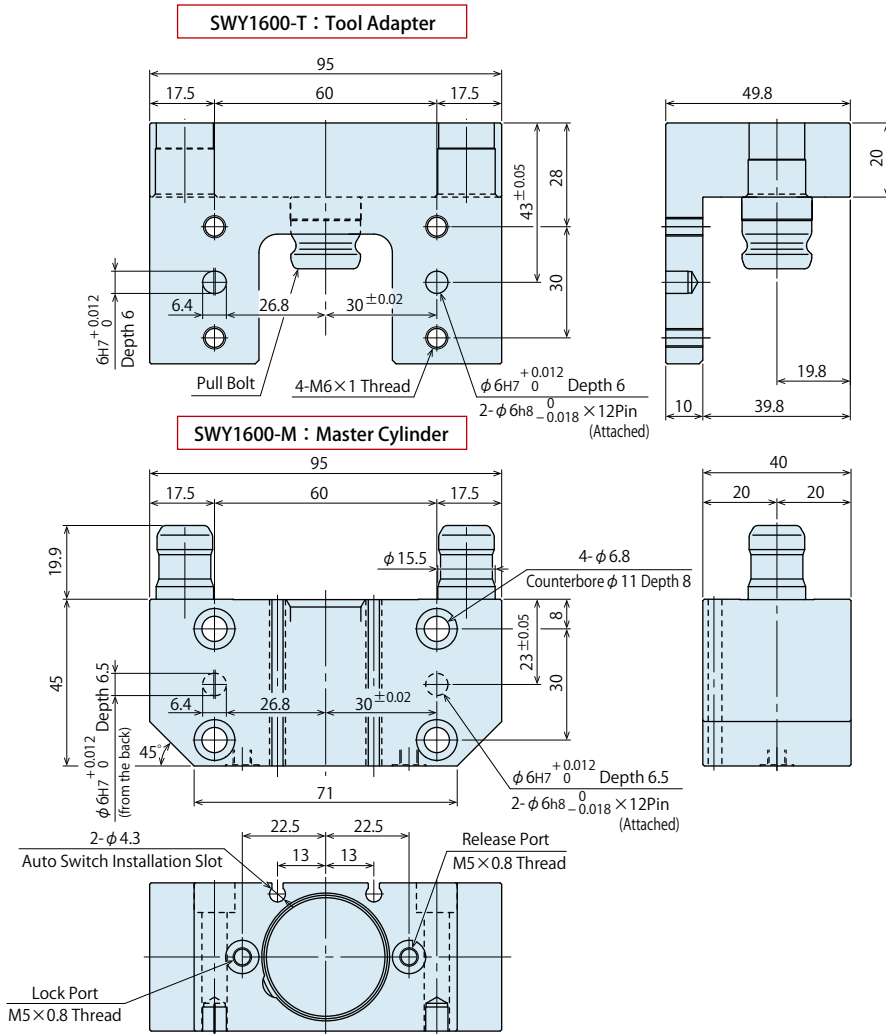

Specifications

Model No.	SWY1600		
Connection Force	kN	Refer to graph	
Connection Holding Force	kN	Refer to graph	
Retaining Force(at OMPa)※1	kN	(0.15)	
Allowable Static Moment N · m	Bending	at 0.3MPa	33
		at 0.4MPa	43
		at 0.5MPa	53
	Twisting	at 0.3MPa	79
		at 0.4MPa	103
		at 0.5MPa	126
Weight	Master Cylinder	0.80	
	Tool Adapter	1.10	
Cylinder Capacity cm ³	Lock	3.36	
	Release	0.74	
Min. Operating Pressure	MPa	0.3	
Max. Operating Pressure	MPa	0.6	
Withstanding Pressure	MPa	1.0	
Operating Temperature	°C	0~70	

Performance Curve

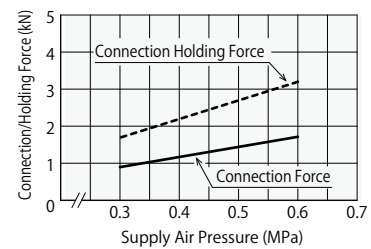

Note :

- ※1. It indicates retaining force when air pressure is at OMPa after locking.
- 1. This product locks with air pressure + spring force, and releases with air pressure.



Product description video of 35kg Payload Pneumatic Quick Chuck Changer is available on our website.

https://www.kosmek.co.jp/php_file/video_products.php?id=235&lang=2



KOSMEK LTD.

<https://www.kosmek.com/>

HEAD OFFICE 1-5, 2-chome, Murotani, Nishi-ku, Kobe-city, Hyogo, Japan 651-2241
TEL.+81-78-991-5162 FAX.+81-78-991-8787

United States of America SUBSIDIARY	KOSMEK (USA) LTD. 650 Springer Drive, Lombard, IL 60148 USA TEL. +1-630-620-7650 FAX. +1-630-620-9015
MEXICO BRANCH OFFICE	KOSMEK USA MEXICO BRANCH OFFICE Av. Loma Pinal de Amoles 320-piso PH oficina 504 interior 13, Vista Dorada, 76060 Santiago de Querétaro, Qro. Mexico TEL. +52-442-851-1377
EUROPE SUBSIDIARY	KOSMEK EUROPE GmbH Schleppeplatz 2 9020 Klagenfurt am Wörthersee Austria TEL. +43-463-287587 FAX. +43-463-287587-20
CHINA SUBSIDIARY	KOSMEK (CHINA) LTD. Room601, RIVERSIDE PYRAMID No.55, Lane21, Pusan Rd, Pudong Shanghai 200125, China TEL. +86-21-54253000
INDIA BRANCH	KOSMEK LTD. - INDIA 4A/Old No:649, Ground Floor, 4th D cross, MM Layout, Kavalbyrasandra, RT Nagar, Bangalore -560032 India TEL.+91-9880561695
THAILAND REPRESENTATIVE OFFICE	KOSMEK Thailand Representation Office 67 Soi 58, RAMA 9 Rd., Phatthanakan, Suanluang, Bangkok 10250, Thailand TEL. +66-2-300-5132 FAX. +66-2-300-5133



WAHLTEC GmbH
T: +49 (7584) 9238883
F: +49 (7584) 9238887
kosmek@wahltec.de
www.wahltec.de

- For Further Information on Unlisted Specifications and Sizes, Please call us.
- Specifications in this Leaflet are Subject to Change without Notice.

