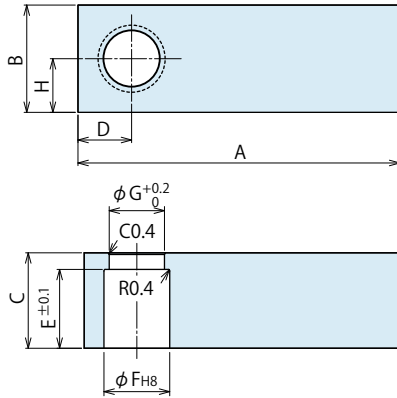

## Accessories : Material Swing Lever for Taper Lock Option

Model No. Indication

# WHZ 160 0 - T

Size  
(Refer to the table.)Design No.  
(Revision Number)

Model No.	WHZ0600-T	WHZ1000-T	WHZ1600-T	WHZ2500-T	WHZ4000-T
Corresponding Model No.	WHE0600-2□□□	WHE1000-2□□□	WHE1600-2□□□	WHE2500-2□□□	WHE4000-2□□□
	WHE0600-2□□□-Y□	WHE1000-2□□□-Y□	WHE1600-2□□□-Y□	WHE2500-2□□□-Y□	WHE4000-2□□□-Y□
A	90	90	125	150	170
B	21	25	28	34	45
C	14	16	18	22	26
D	10.5	12.5	14	17	23
E	11	13	15	18	22
F	14 <sup>+0.027</sup> / <sub>0</sub>	16 <sup>+0.027</sup> / <sub>0</sub>	18 <sup>+0.027</sup> / <sub>0</sub>	22 <sup>+0.033</sup> / <sub>0</sub>	28 <sup>+0.033</sup> / <sub>0</sub>
G	11	13	15	17	23.5
H	10.5	12.5	14	17	22.5

Notes :

1. Material : S50C
2. If necessary, the front end should be additionally machined.
3. When determining the phase, refer to taper lock lever design dimensions for each model for the additional machining.
- ※6. Refer to Accessory of Quick Change Lever Type F for -F (Quick Change Lever Type F). For -P (Balance Lever Option), it should be designed by customer.

## Accessories : Material Swing Lever for Quick Change Option

Model No. Indication

# WHZ 160 0 - F

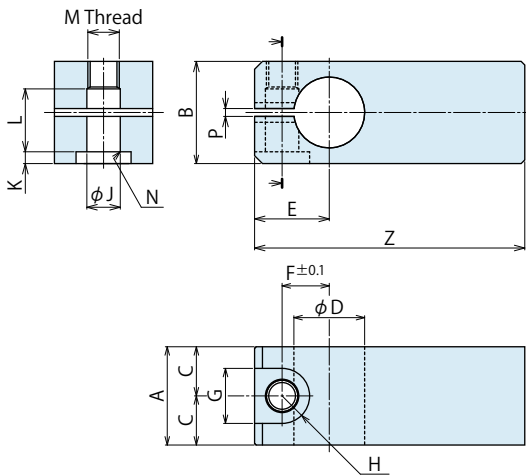
Size  
(Refer to the table.)Design No.  
(Revision Number)

Model No.	WHZ0600-F	WHZ1000-F	WHZ1600-F	WHZ2500-F	WHZ4000-F
Corresponding Model No.	WHE0600-2□□□-F	WHE1000-2□□□-F	WHE1600-2□□□-F	WHE2500-2□□□-F	WHE4000-2□□□-F
A	16	19	22	30	34
B	19	22	25	30	36
C	8	9.5	11	15	17
D	12 <sup>0</sup> / <sub>-0.016</sub>	14 <sup>0</sup> / <sub>-0.016</sub>	16 <sup>0</sup> / <sub>-0.016</sub>	20 <sup>0</sup> / <sub>-0.016</sub>	25 <sup>0</sup> / <sub>-0.020</sub>
E	13	15	18	22	26.5
F	7.75	9.25	11	13.75	17
G	10	11	14	17.5	20
H	R5	R5.5	R7	R8.75	R10
J	5.5	6.5	8.5	10.5	12.5
K	1.5	2	3	2	4
L	11.5	13.5	15.5	18	22
M	M5×0.8	M6×1	M8×1	M10×1.25	M12×1.5
N	C0.4	C0.4	C0.6	C0.6	C1
P	2	2	2	2	2
Z	95	105	120	150	170

Notes :

1. Material S50C
2. If necessary, the front end should be additionally machined.
3. When determining the phase, refer to quick change lever design dimensions for each model for the additional machining.
4. Tightening Bolt (WHZ□□0-B) for Quick Change Lever is sold separately.

## Accessories : Tightening Bolts for Quick Change Lever

Model No. Indication

# WHZ 160 0 - B

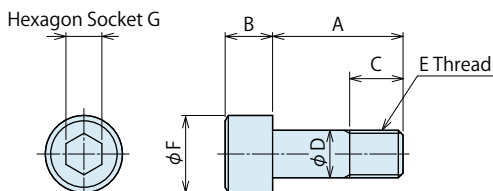
Size  
(Refer to the table.)Design No.  
(Revision Number)

Model No.	WHZ0600-B	WHZ1000-B	WHZ1600-B	WHZ2500-B	WHZ4000-B
Corresponding Model No.	WHE0600-2□□□-F	WHE1000-2□□□-F	WHE1600-2□□□-F	WHE2500-2□□□-F	WHE4000-2□□□-F
A	17.5	20	22	28	32
B	5	6	8	10	12
C	6.5	7	9	11	13
D	5	6	8	10	12
E	M5×0.8	M6×1	M8×1	M10×1.25	M12×1.5
F	8.5	10	13	16	18
G	4	5	6	8	10

High-Power  
Series

Pneumatic Series

Hydraulic Series

Valve / Coupler  
Hydraulic UnitManual Operation  
Accessories

Cautions / Others

High-Power Hydraulic  
Swing Clamp

LHE

High-Power Hydraulic  
Link Clamp

LKE

High-Power Pneumatic  
Hole Clamp

SWE

High-Power Pneumatic  
Swing Clamp

WHE

High-Power Pneumatic  
Link Clamp

WCE

High-Power Pneumatic  
Work Support

WNC

Rodless Hollow  
Pneumatic Work Support

WNA

High-Power Pneumatic  
Pallet Clamp

WVS

## Accessories : Material Swing Lever for Taper Lock Option

Model No. Indication

# WHZ 040 0 - T

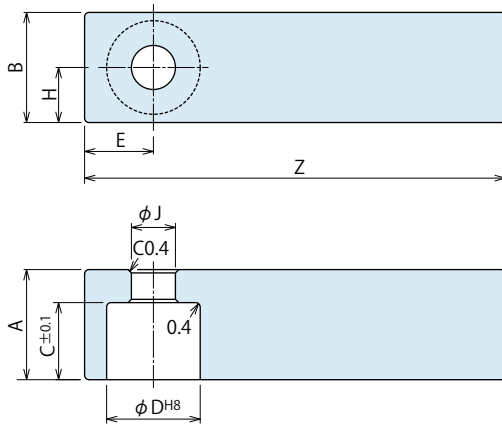
Size  
(Refer to the table.)Design No.  
(Revision Number)

## Material Swing Lever for Quick Change Option

Model No. Indication

# WHZ 040 0 - F

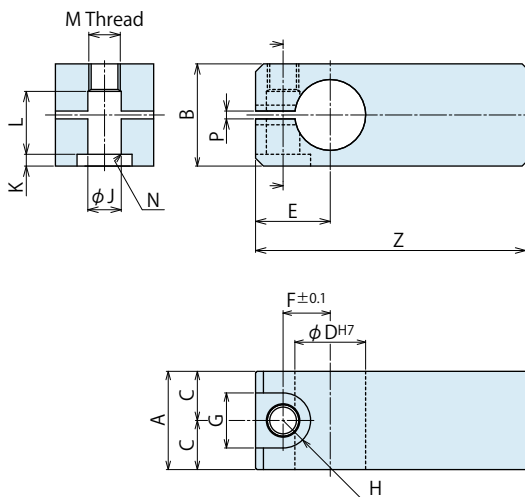
Size  
(Refer to the table.)Design No.  
(Revision Number)

## Tightening Bolts for Quick Change Lever

Model No. Indication

# LZH 036 0 - B

Size  
(Refer to the table.)Design No.  
(Revision Number)

Hexagon Socket G

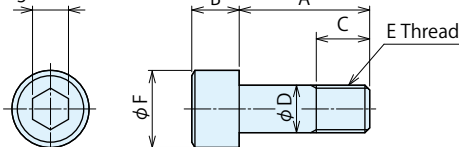

(mm)

Model No.	WHZ0320-T	WHZ0400-T	WHZ0500-T	WHZ0630-T
Corresponding Model No.	WHA0320-2□□ WHA0320-2□□-Q25	WHA0400-2□□ WHA0400-2□□-Q25	WHA0500-2□□ WHA0500-2□□-Q25	WHA0630-2□□ WHA0630-2□□-Q25
A	20	22	28	35
B	20	22	28	35
C	14	18	22	24
D	17 <sup>+0.027</sup> <sub>0</sub>	19 <sup>+0.033</sup> <sub>0</sub>	24 <sup>+0.033</sup> <sub>0</sub>	29 <sup>+0.033</sup> <sub>0</sub>
E	12.5	13	16	19
H	10	11	14	17.5
J	9	9	11	14
Z	90	125	150	180

Notes :

1. Material S45C
2. If necessary, the front end should be additionally machined.
3. When determining the phase, refer to taper lock lever design dimensions for each model for the additional machining.

(mm)

Model No.	WHZ0320-F	WHZ0400-F	WHZ0500-F	WHZ0630-F
Corresponding Model No.	WHA0320-2□□-F	WHA0400-2□□-F	WHA0500-2□□-F	WHA0630-2□□-F
A	20	22	28	35
B	22	22	26	32
C	10	11	14	17.5
D	14 <sup>+0.018</sup> <sub>0</sub>	16 <sup>+0.018</sup> <sub>0</sub>	20 <sup>+0.021</sup> <sub>0</sub>	25 <sup>+0.021</sup> <sub>0</sub>
E	14.5	15.5	20	24.5
F	9.25	10.25	13	16.25
G	11	11	14	17.5
H	R5.5	R5.5	R7	R8.75
J	6.5	6.5	8.5	10.5
K	2	2	3	4
L	13.5	13.5	16	18
M	M6×1	M6×1	M8×1	M10×1.25
N	C0.4	C0.4	C0.6	C0.6
P	2	2	2	2
Z	90	125	150	180

Notes :

1. Material S45C
2. If necessary, the front end should be additionally machined.
3. When determining the phase, refer to quick change lever design dimensions for each model for the additional machining.
4. Tightening Bolt (LZH□□0-B) for Quick Change Lever is sold separately.

(mm)

Model No.	LZH0360-B	LZH0400-B	LZH0480-B
Corresponding Model No.	WHA0320-2□□-F / WHA0400-2□□-F	WHA0500-2□□-F	WHA0630-2□□-F
A	20	23	28
B	6	8	10
C	7	10	11
D	6	8	10
E	M6×1	M8×1	M10×1.25
F	10	13	16
G	5	6	8

High-Power  
Series

Pneumatic Series

Hydraulic Series

Valve / Coupler  
Hydraulic UnitManual Operation  
Accessories

Cautions / Others

Pneumatic  
Hole Clamp

SWA

Pneumatic  
Swing Clamp

WHA

Double Piston  
Pneumatic Swing Clamp

WHD

Pneumatic  
Link Clamp

WCA

Air Flow  
Control Valve

BZW

Pneumatic  
Expansion Locating Pin

VWM

VWK

Pneumatic Sensor Pin

WWA