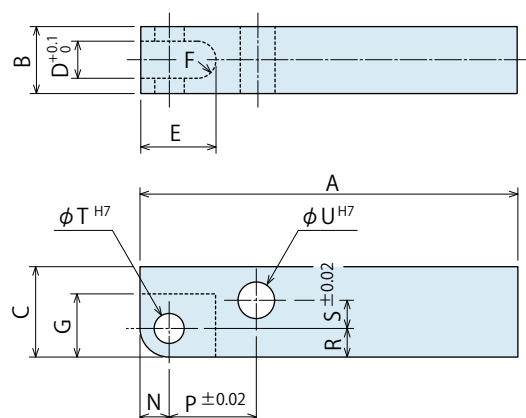

Accessories : Material Link Lever

Model No. Indication

WCZ 160 0 - L2

 Size
 (Refer to following table)

 Design No.
 (Revision Number)

Model No.	WCZ0600-L2	WCZ1000-L2	WCZ1600-L2	WCZ2500-L2	WCZ4000-L2
Corresponding Model No.	WCE0602	WCE1002	WCE1602	WCE2502	WCE4002
A	80	90	100	115	140
B	10 _{-0.2} ⁰	10 _{-0.2} ⁰	12 _{-0.3} ⁰	16 _{-0.3} ⁰	19 _{-0.3} ⁰
C	12.5	12.5	16	20	25
D	5	5	6	8	10
E	12.5	12.5	16	17	22
F	R2.5	R2.5	R3	R4	R5
G	10	10	13	13	17.5
N	4.5	4.5	6	6	8
P	16	19.5	21	25	30
R	4.5	4.5	6	6	8
S	2.5	2.5	3.5	6	7.5
T	5 ₀ ^{+0.012}	5 ₀ ^{+0.012}	6 ₀ ^{+0.012}	6 ₀ ^{+0.012}	8 ₀ ^{+0.015}
U	5 ₀ ^{+0.012}	5 ₀ ^{+0.012}	6 ₀ ^{+0.012}	8 ₀ ^{+0.015}	10 ₀ ^{+0.015}

Notes:

1. Material S45C
2. If necessary, the front end should be additionally machined.
3. Please use the attached pin (equivalent to ϕ ADf6, ϕ AEF6, HRC60) as the mounting pin for lever.
(Refer to the external dimensions for ϕ AD, ϕ AE)

Accessories : Others

- We offer other accessories shown below.

Air Flow Control Valve

 Model **BZW-A**

※Please use BZW□-A for WCE.



Refer to P.283 for detail.

Manifold Block

 Model **WHZ-MD**

Refer to P.1217 for detail.

High-Power Series

Pneumatic Series

Hydraulic Series

 Valve / Coupler
 Hydraulic Unit

 Manual Operation
 Accessories

Cautions / Others

 High-Power Hydraulic
 Swing Clamp

LHE

 High-Power Hydraulic
 Link Clamp

LKE

 High-Power Pneumatic
 Hole Clamp

SWE

 High-Power Pneumatic
 Swing Clamp

WHE

 High-Power Pneumatic
 Link Clamp

WCE

 High-Power Pneumatic
 Work Support

WNC

 Rodless Hollow
 Pneumatic Work Support

WNA

 High-Power Pneumatic
 Pallet Clamp

WVS

Accessories : Material Link Lever

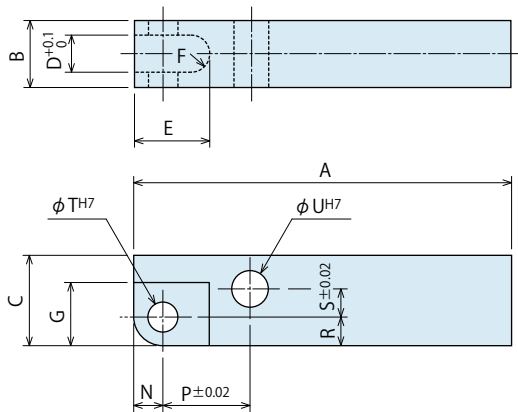

Model No. Indication

WCZ 040 0 - L2

Size
(Refer to following table)Design No.
(Revision Number)

(mm)

Model No.	WCZ0320-L2	WCZ0400-L2	WCZ0500-L2	WCZ0630-L2
Corresponding Model No.	WCA0321	WCA0401	WCA0501	WCA0631
A	90	100	115	140
B	10 ⁰ _{-0.2}	12 ⁰ _{-0.3}	16 ⁰ _{-0.3}	19 ⁰ _{-0.3}
C	12.5	16	20	25
D	5	6	8	10
E	12.5	16	17	22
F	R2.5	R3	R4	R5
G	10	13	13	17.5
N	4.5	6	6	8
P	19.5	21	25	30
R	4.5	6	6	8
S	2.5	3.5	6	7.5
T	5 ^{+0.012} ₀	6 ^{+0.012} ₀	6 ^{+0.012} ₀	8 ^{+0.015} ₀
U	5 ^{+0.012} ₀	6 ^{+0.012} ₀	8 ^{+0.015} ₀	10 ^{+0.015} ₀

Notes :

1. Material S45C
2. If necessary, the front end should be additionally machined.
3. Please use the provided pin (equivalent to φ ADf6, φ AEF6, HRC60) as the mounting pin for lever.
(Please refer to each external dimension of WCA for the dimensions φ AD and φ AE.)

High-Power
Series

Pneumatic Series

Hydraulic Series

Valve / Coupler
Hydraulic UnitManual Operation
Accessories

Cautions / Others

Pneumatic
Hole Clamp

SWA

Pneumatic
Swing Clamp

WHA

Double Piston
Pneumatic Swing Clamp

WHD

Pneumatic
Link Clamp

WCA

Air Flow
Control Valve

BZW

Pneumatic
Expansion Locating Pin

WWM

WVK

Pneumatic Sensor Pin

WWA

● Accessories : Material Link Lever

Model No. Indication

WCZ 160 0 - L3

Size
(Refer to following table)

Design No.
(Revision Number)

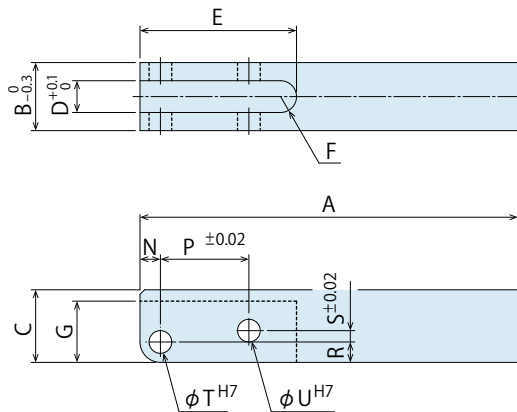

Model No.	WCZ1000-L3	WCZ1600-L3	WCZ2500-L3	WCZ4000-L3
Corresponding Model No.	WCG1000	WCG1600	WCG2500	WCG4000
A	90	100	115	140
B	15	16	19	25
C	16	20	24	30
D	7	7	8	12
E	35.5	39.5	46	56
F	R3.5	R3.5	R4	R6
G	13.5	17	21	26.5
N	4.5	6	6	8
P	19.5	21	25	30
R	4.5	6	6	8
S	2.5	3.5	6	7.5
T	5 ^{+0.012} ₀	6 ^{+0.012} ₀	6 ^{+0.012} ₀	8 ^{+0.015} ₀
U	5 ^{+0.012} ₀	6 ^{+0.012} ₀	8 ^{+0.015} ₀	10 ^{+0.015} ₀

Notes :

1. Material S45C
2. If necessary, the front end should be additionally machined.
3. Please use the attached pin (equivalent to ϕ ADf6, ϕ AEf6, HRC60) as the mounting pin for lever.
(Refer to the external dimensions for ϕ AD, ϕ AE)

Locating
Pin Clamp

SWP

High-Power
Welding
Swing Clamp

WHG

High-Power
Welding
Link Clamp

WCG

Air Flow
Control Valve

BZW

Manifold
Block

WHZ-MD

General Cautions

Welding
Related Products

Quick Die
Change Systems

Company Profile
Sales Offices