

For Resin Molded Products

Pneumatic Swing Clamp

model **WHC**



Rigid, High Durability

Stopper or Guide Not Required

Adaptor Bracket Available

Used for fixing various plastic products such as headlamps and interior/exterior automotive resin molded products.

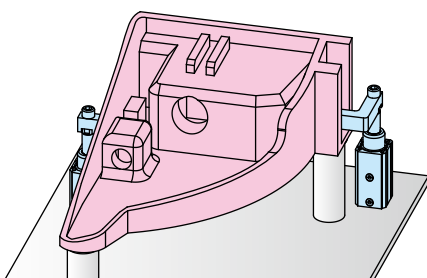

Assembly Fixture Headlamps, etc.

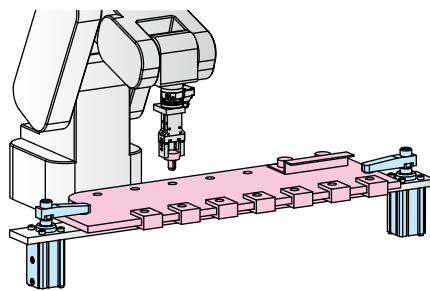

Assembly • Press-Fit Fixture Clips, etc.

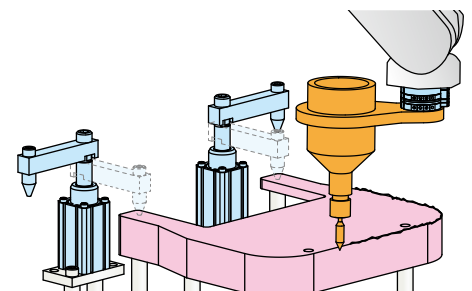

Deburring Fixture Molded Parts for Vehicles, etc.

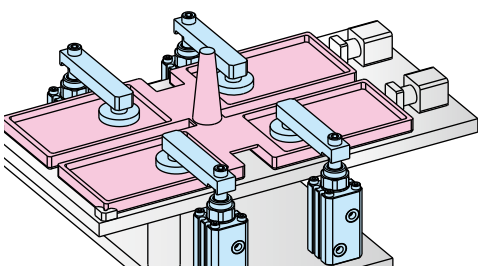

Gate Cutting Fixture Small Plastic Products, etc.

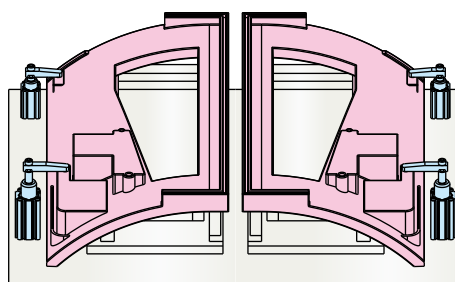

Inspection Fixture Leak Test, etc.

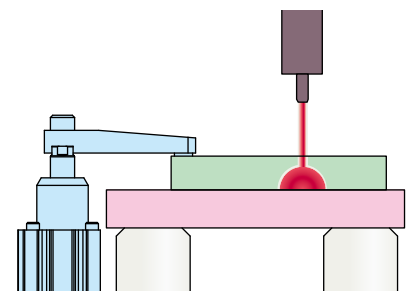

Laser Welding Fixture Dissimilar Material Welding, etc.

Model No. Indication / Specifications

Model No. **WHC 032 1 - R -**

1 Design No. 2 3

1 Cylinder Inner Diameter

016 : Cylinder I.D. = ϕ 16mm **032** : Cylinder I.D. = ϕ 32mm
020 : Cylinder I.D. = ϕ 20mm **040** : Cylinder I.D. = ϕ 40mm

2 Swing Direction when Clamping

R : Clockwise

L : Counter-Clockwise

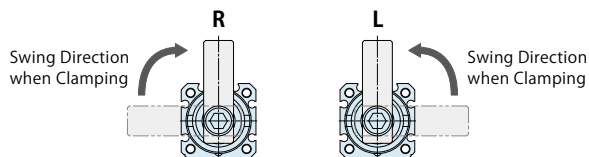

3 Option

Blank : Standard (Vertical Stroke 10mm)
Q20 : Long Stroke Option (Vertical Stroke 20mm)
Q30 : Long Stroke Option (Vertical Stroke 30mm)
 ※ Only **Blank**:Standard can be selected in case of 1 **016**.

Action Description

Swing to avoid interference

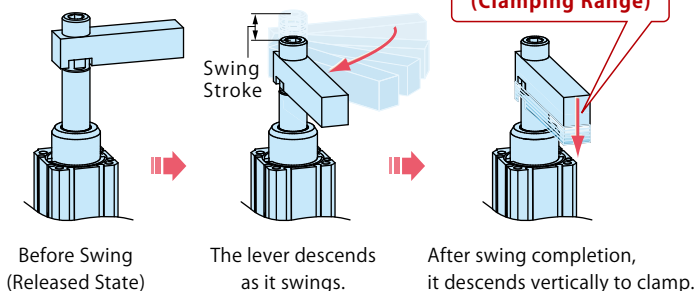

Pneumatic Clamp with Rectangular Body



Model No.		WHC0161-□	WHC0201-□-□	WHC0321-□-□	WHC0401-□-□
Cylinder Area for Locking	cm ²	1.51	2.01	6.03	10.56
Cylinder Inner Diameter ※1	mm	16	20	32	40
Rod Diameter ※1	mm	8	12	16	16
Operating Pressure Range	MPa	0.1 ~ 1.0			
Operating Temperature	°C	0 ~ 70			
Usable Fluid		Dry Air			
90° Swing Angle Accuracy		90° ± 3°			
Swing Completion Position Repeatability※2		±0.75°	±0.5°	±0.5°	±0.5°

Notes : ※1. Clamping force cannot be calculated from the cylinder inner diameter and rod diameter. Please refer to the product catalog.

※2. It shows the value within the vertical stroke range.



KOSMEK LTD.

► <https://www.kosmek.com/>

HEAD OFFICE 1-5, 2-chome, Murotani, Nishi-ku, Kobe-city, Hyogo, Japan 651-2241
 TEL.+81-78-991-5162 FAX.+81-78-991-8787

United States of America SUBSIDIARY	KOSMEK (USA) LTD. 650 Springer Drive, Lombard, IL 60148 USA TEL. +1-630-620-7650 FAX. +1-630-620-9015
MEXICO REPRESENTATIVE OFFICE	KOSMEK USA Mexico Office Av. Santa Fe 103, Int. 59, col. Santa Fe Juriquilla, Queretaro, QRO, 76230, Mexico TEL. +52-442-851-1377
EUROPE SUBSIDIARY	KOSMEK EUROPE GmbH Schleppeplatz 2 9020 Klagenfurt am Wörthersee Austria TEL. +43-463-287587 FAX. +43-463-287587-20
CHINA SUBSIDIARY	KOSMEK (CHINA) LTD. Room601, RIVERSIDE PYRAMID No.55, Lane21, Pusan Rd, Pudong Shanghai 200125, China TEL. +86-21-54253000
INDIA BRANCH OFFICE	KOSMEK LTD. - INDIA 4A/Old No:649, Ground Floor, 4th D cross, MM Layout, Kavalbyrasandra, RT Nagar, Bangalore -560032 India TEL.+91-9880561695
THAILAND REPRESENTATIVE OFFICE	KOSMEK Thailand Representation Office 67 Soi 58, RAMA 9 Rd., Phatthanakan, Suanluang, Bangkok 10250, Thailand TEL. +66-2-300-5132 FAX. +66-2-300-5133



WAHLTEC GmbH
 T: +49 (7584) 9238883
 F: +49 (7584) 9238887
 kosmek@wahltec.de
 www.wahltec.de

- For Further Information on Unlisted Specifications and Sizes, Please call us.
- Specifications in this Leaflet are Subject to Change without Notice.



JQA-QMA10823
 KOSMEK HEAD OFFICE